

## Features

- Low insertion loss
- High channel isolation
- Low polarization dependent loss
- Exceptional reliability and stability

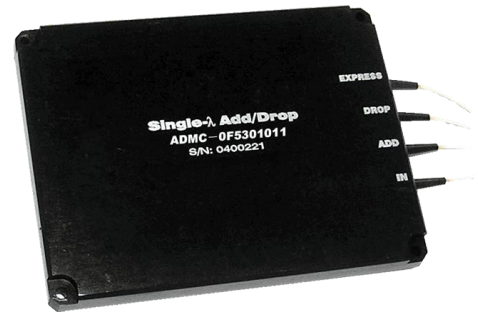

## Applications

- Access networks
- Long-haul WDM systems
- Metro WDM systems
- Enterprise networks

## Product Description

Primanex single channel add/drop modules demonstrate low loss, temperature insensitivity, and reliable performance in any system application, and are available for ITU channel spacing of 100 and 200 GHz.

Fixed add/drop modules offer low-cost wavelength management solutions that are suitable for metro and access applications. Easily customizable, these devices are configured by number of channels for any customer-specific channel plan.

Established volume capability and proven experience in customizing fiber optic components and modules make Primanex the supplier of choice.

## Specifications

Item	Unit	Parameters		Notes
Channel Spacing	GHz	100	200	
Wavelength Range	nm	C, L, or C+L band		
Channel Centers	nm	ITU		
Pass Band Width	GHz	≥ +/- 12.5	≥ +/- 33	
Pass Band Ripple	dB	≤ 0.5		
Add/Drop Insertion Loss (single-λ)	dB	≤ 1.1		
Add/Drop Insertion Loss (dual-λ)	dB	≤ 1.8		
Express Insertion Loss (single-λ)	dB	≤ 0.9		
Express Insertion Loss (dual-λ)	dB	≤ 1.4		
Drop Isolation (adj channel)	dB	≥ 30		
Drop Isolation (non-adj channel)	dB	≥ 50		
Express Isolation	dB	≥ 25		
Polarization Dependent Loss	dB	≤ 0.2		
Polarization Mode Dispersion	ps	≤ 0.2		
Directivity	dB	≥ 50		
Return Loss	dB	≥ 45		
Optical Power Handling	mW	≤ 500		
Operating Temperature Range	°C	-5 to 70		
Storage Temperature Range	°C	-40 to +85		
Fiber Type	NA	SMF-28e+		Other fiber is optional
Package Dimension	mm	100×80×10		ABS

\*. All the specifications are based on the devices without connectors, and guaranteed over wavelength, polarization and temperature.

\*\* Specifications are subject to change without notice.

## Dimensions Drawing (Unit: mm)

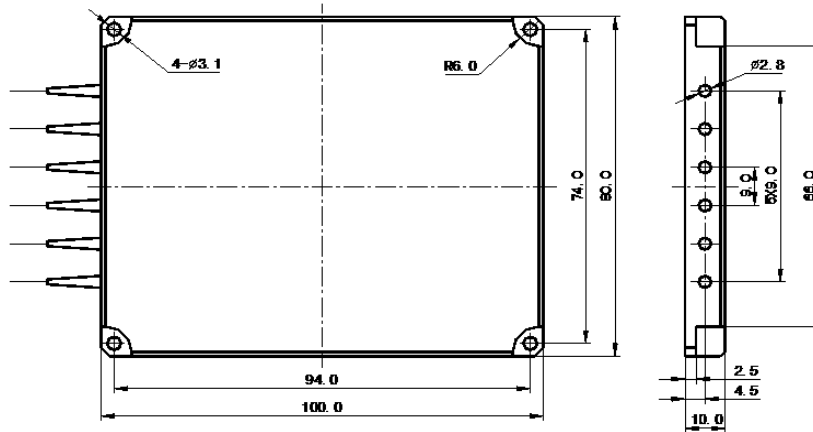

## Spectral Plot 100GHz coupler

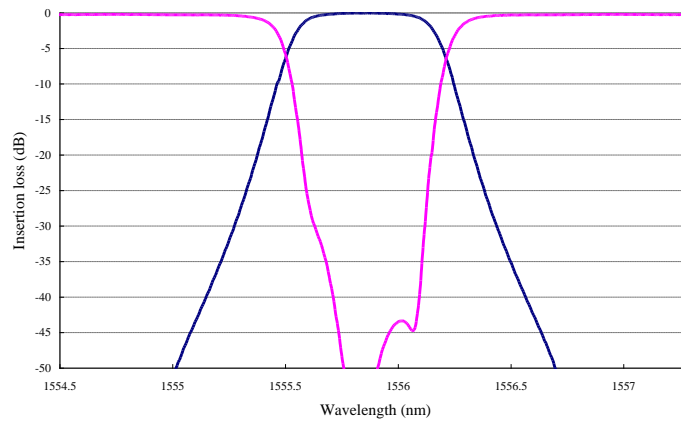

## Ordering Information(Example:ADMD-1FC3410120)

Channel Spacing	Channel Frequency Code	Code Channel Number	Fiber Length	Connector Type
1. 100 GHz	Provided by Primanex upon customer confirmation	101、Single Channel	1. 0.5 +/- 0.1 m	0. No Connector
2. 200 GHz		202、Dual Channel	2. 1.0 +/- 0.1 m	1. FC/UPC
		909、Custom	3. Others	2. FC/APC
				3. SC/UPC
				4. SC/APC
				5. Others

All statements, technical information and recommendations related to the products herein are based upon information believed to be reliable or accurate. However, the accuracy or completeness thereof is not guaranteed, and no responsibility is assumed for any inaccuracies. The user assumes all risks and liability whatsoever in connection with the use of a product or its application. Primanex reserves the right to change at any time without notices the design, specifications, function, fit or form of its products described herein, including withdrawal at any time of a product offered for sale herein. Primanex makes no representations that the products herein are free from any intellectual property claims of others. Please contact Primanex for more information. Primanex and the Primanex logo are trademarks of Primanex Corporation. Other trademarks are the property of their respective holders.